



Abesco FR Mortar

Technical Data Sheet

Product Description

Abesco Fire Rated Mortar is designed to maintain the fire resistance of compartment walls and floors.

Abesco Fire Rated Mortar is a pre-mixed dry blend, consisting of inorganic fillers and foamed perlite. When mixed with water it produces a trowelable or pourable grade non-spalling, thermally insulating fire seal. Whilst curing, the mortar expands by approximately 1% ensuring a tight seal around penetrations and within the opening. Once installed Abesco Fire Rated Mortar sets within approximately 30 minutes allowing works to be completed without the need to re-visit the site.

Fire Rated Mortar Features:

Expands slightly during cure

Suitable for large or small irregular openings

Easy to use

Simple to retro-fit additional services

Does not spall

Application

Abesco Fire Rated Mortar is particularly suitable for reinstating compartment floors where HVAC ducts, plastic pipes, and electrical services have been installed. Small irregular holes and imperfections of fit can easily be repaired using Abesco Fire Rated Mortar.

Physical Properties

Physical State:	Free flowing powder
Colour:	Off-white
Nominal Dry density:	Approximately 72 lb / cubic feet
Flash Point:	N/A
Solubility in water:	Approximately 1%

Specifications

All installations shall be in strict accordance with manufacturers printed instructions and shall be tested in accordance with ASTM E814 (UL1479) and classified by Underwriters Laboratories Inc.

Testing and Performance Data

Tested in Accordance with:

ASTM E814 (UL1479)

BS 476 part 20

AS 1530 part 4

EN1366-3

SABS 0177 part 2

NS EN 1363-1

UL Classified 1 and 2 Hour rating

Please visit the UL website for details on our current systems



FILL VOID OR CAVITY MATERIALS FOR USE IN THROUGH PENETRATION FIRESTOP SYSTEMS SEE UL DIRECTORY OF PRODUCTS CERTIFIED FOR CANADA AND UL FIRE RESISTANCE DIRECTORY 86JY

As part of our policy of ongoing improvement, we reserve the right to modify, alter or change product specifications without giving notice. Product illustrations are representations only. All information contained in this document is provided for guidance only, and as Abesco Limited has no control over the installation methods of the products, or of the prevailing site conditions, no warranties expressed or implied are intended to be given as to the actual performance of the products mentioned or referred to, and no liability whatsoever will be accepted for any loss, damage or injury arising from the use of the information given of products mentioned or referred to herein.

Abesco LLC
Unit 325
9561 Satellite Blvd.
Orlando, FL 32837
USA
Tel: 888-FIRESTP
Fax: 407-851-3388

Abesco Ltd, Abesco House
Laurencekirk Business Park
Laurencekirk
Scotland, UK
AB30 1EY
Tel: +44 (0) 1561-377766
Fax: +44 (0) 1561-378887

Installation Methods

- 1 Ensure all service penetrations are complete and installed to the manufacturers recommendations
- 2 Remove dust and debris by brushing out the opening and surrounding area
- 3 Friction fit 2" thick mineral fiber batt shutter within the thickness of the floor. To ensure a good seal, Abesco CP310 FR Intumescent Acrylic Mastic can be applied to all joints in the mineral fibre. A temporary timber shutter can be used in place of the permanent mineral fiber, but this should be removed once the seal is cured.
- 4 Pour clean potable water into a suitable mixing vessel and add sufficient dry FR Mortar to achieve the required consistency, stirring the slurry to remove all lumps. The normal mixing ratios are:

2.5 parts FR Mortar : 1 part Water Pourable mix

3 parts FR Mortar : 1 part Water Trowelable mix

4 parts FR Mortar : 1 part Water Hand Batch mix

IMPORTANT: ALWAYS ADD THE DRY POWDER TO THE WATER

- 5 Pour or trowel apply the mix onto the mineral fiber shutter, and build up to the required thickness with further applications (if required).
- 6 Abesco FR Mortar normally sets within approximately 30 mins (dependent on environmental conditions). To achieve a full cure can take up to approx. 28 days.

Typical Installations

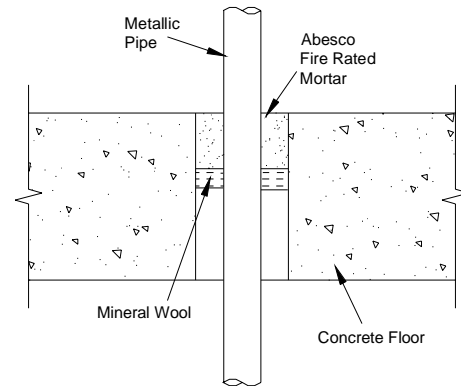

Metallic Pipe through Concrete Floor

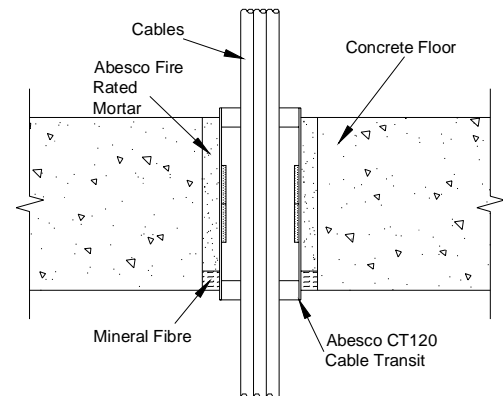

Cables through Concrete Floor

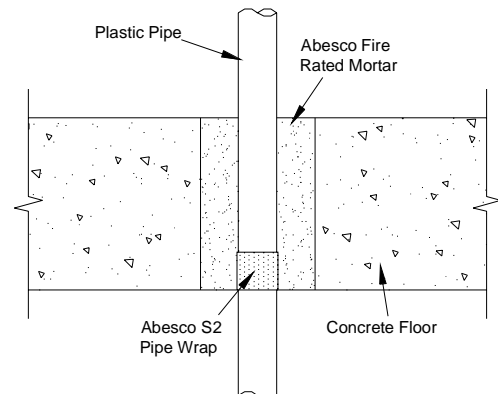

Plastic Pipe through Concrete Floor

As part of our policy of ongoing improvement, we reserve the right to modify, alter or change product specifications without giving notice. Product illustrations are representations only. All information contained in this document is provided for guidance only, and as Abesco Limited has no control over the installation methods of the products, or of the prevailing site conditions, no warranties expressed or implied are intended to be given as to the actual performance of the products mentioned or referred to, and no liability whatsoever will be accepted for any loss, damage or injury arising from the use of the information given of products mentioned or referred to herein.

Abesco LLC
Unit 325
9561 Satellite Blvd.
Orlando, FL 32837
USA
Tel: 888-FIRESTP
Fax: 407-851-3388

Abesco Ltd, Abesco House
Laurencekirk Business Park
Laurencekirk
Scotland, UK
AB30 1EY
Tel: +44 (0) 1561-377766
Fax: +44 (0) 1561-378887